

DENWA PREMIUM



QUICK
INSTALLATION
GUIDE

www.denwaip.com





Verifique los datos de su licencia en
cloud.denwaip.com



Check the product package and contents for specific features supported. Specifications are subject to change without notice. Denwa is a registered trademark or trademark of GlobalThink Technology S.A. and/or its affiliates in the U.S. and certain other countries. Copyright 2010.

GlobalThink Technology S.A. All rights reserved. Other brands and product names are trademarks or registered trademarks of their respective holders.

Reliable, easy and powerful
UNIFIED COMMUNICATION PLATFORM

Denwa Premium is a solution that we offer to Service Providers (Carriers) and Companies; it is a crucial part for the migration of your communications to VoIP that includes a Session Border Controller (E-SBC) in its UNIFIED COMMUNICATION PLATFORM.

The E-SBC offers the interoperability, survival, security and quality control that are needed for internet connection by a SIP protocol.

Form the Business point of view, Denwa E-SBC is the checkpoint between the company's VoIP network and services based on Service Providers SIP, such as the SIP Trunk or the Unified Communication apps on the cloud, Denwa E-SBC also allows the connectivity of the extensions based on SIP placed in the company LAN network or in remote extensions through WAN interface allowing teleworking.

With Denwa Premium, your company has an armor that protects your communications in case of attacks.

KIT REVISION

Inside the box

- 1 Denwa UC Premium DWP-M808A model.
- 2 Power Cable.
- 3 Installation Manual and License.
- 4 Rack and wall mounting.
- 5 Screw and rubber feet.

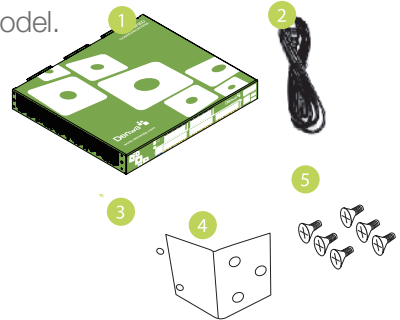

Frontal Panel / Description

- | | |
|----------------|--------------------------------|
| 1 USB | USB for external peripherals . |
| 2 Led Power | Power LED indicator. |
| 3 Led Status | Disk activity LED indicator . |
| 4 Reset button | Press to reset the central. |
| 5 RS-232 | Connection by Console. |
| 6 8FXO | 8 FXO ports |
| 7 WAN | WAN port |
| 8 SWITCH PoE | 12 port with SWITCH PoE |

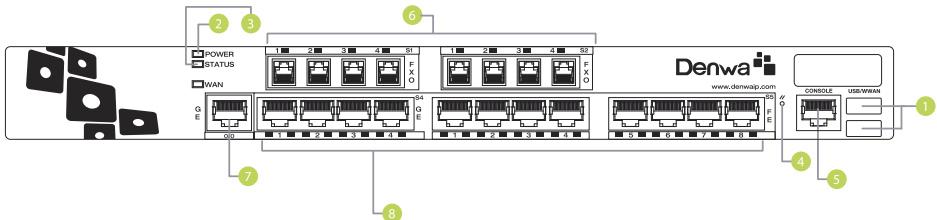

The figures are used as examples.

NOTE The number and type of interfaces depend on the required configurations.

KIT REVISION

Inside the box

- 1 Denwa UC Premium DWP-M801D model.
- 2 Power Cable.
- 3 Installation Manual and License.
- 4 Rack and wall mounting.
- 5 Screw and rubber feet.

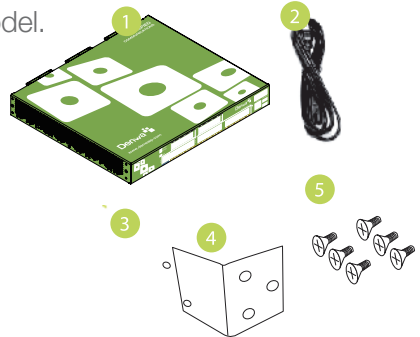

Frontal Panel / Description

- | | |
|-------------------|-------------------------------|
| 1 USB | USB for external peripherals. |
| 2 Led Power | Power LED indicator. |
| 3 Led Status | Disk activity LED indicator . |
| 4 Reset button | Press to reset the central. |
| 5 RS-232 | Connection by console. |
| 6 E1 ISDN/R2 port | 1 E1 port |
| 7 WAN | Puerto WAN |
| 8 SWITCH PoE | 12 ports with SWITCH PoE |

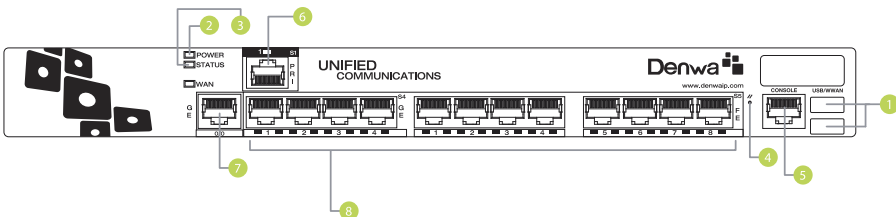

NOTE The figures are used as examples.
The number and type of interfaces depend on the required configurations.

Rear panel / Description

Inside the box

- | | | |
|---|----------|-------------------------------|
| 1 | USB | USB for external peripherals. |
| 2 | VGA | VGA monitor Port Connection. |
| 3 | GE1 | Gigabit Ethernet 1 port. |
| 4 | Ground | Ground connection. |
| 5 | 110-240V | Power Input 110-240V – 2.5A |

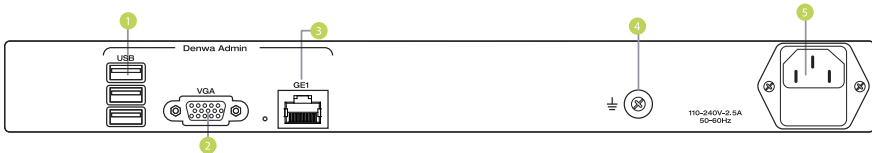

The figures are used as examples.

NOTE The number and type of interfaces depend on the required configurations.

POSSIBLE POSITIONS

Rack Mounting

1. Put the rack mounting kit (provided) on each side.
2. Use the 6 (six) screws (provided) to fix mountings to the equipment.

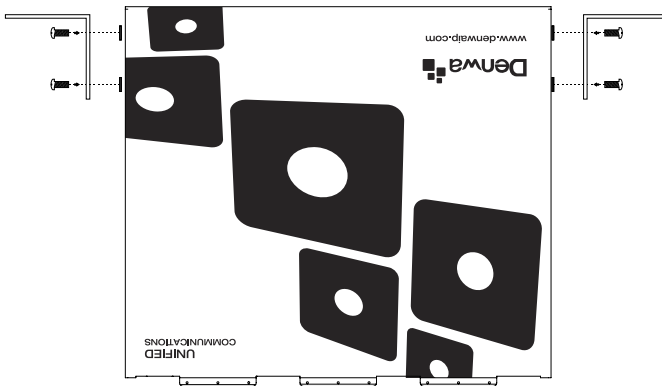

The mountings are reversible with the front and the back of the equipment.

NOTE Screws for rack are not provided.

1. Put the rack mounting kit (provided) to each side.
2. Use the 6 (six) screws (provided) to fix the mountings to the equipment.

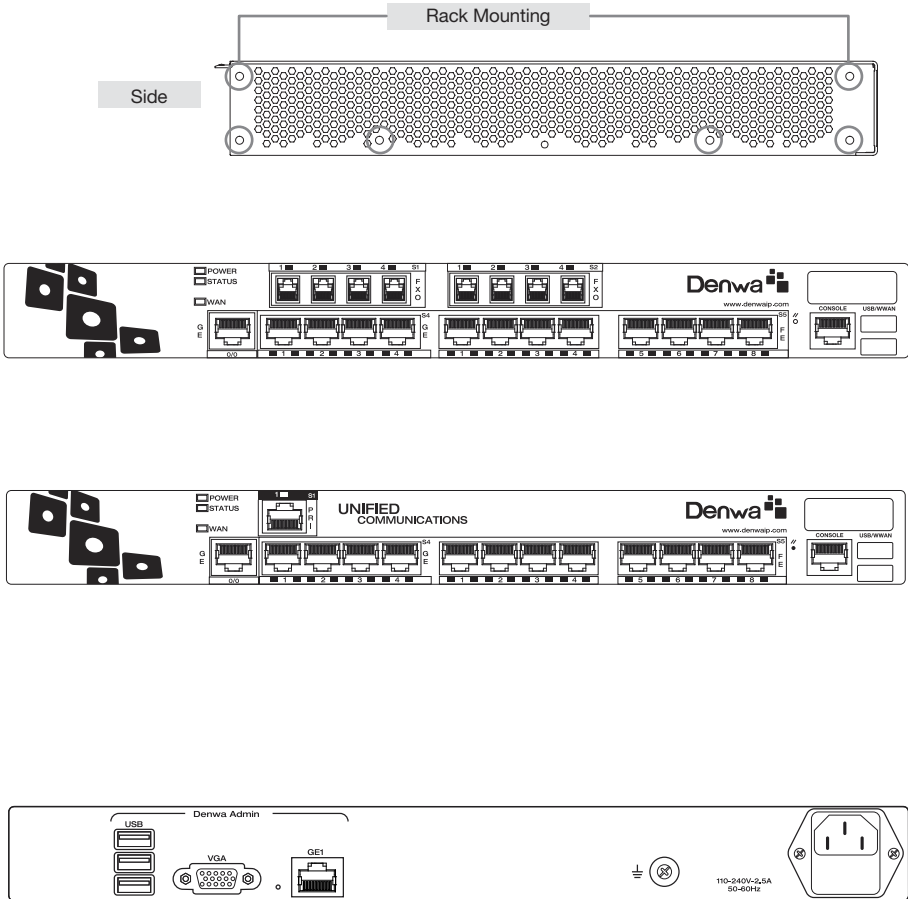

The mountings are reversible with the front and the back of the equipment.
Screws for rack are not provided.

RACK ASSEMBLY

1. Remove the protective film from the rubber feet.
2. Put the rubber feet in the indicated place below the central.
3. Paste the rubber feet.

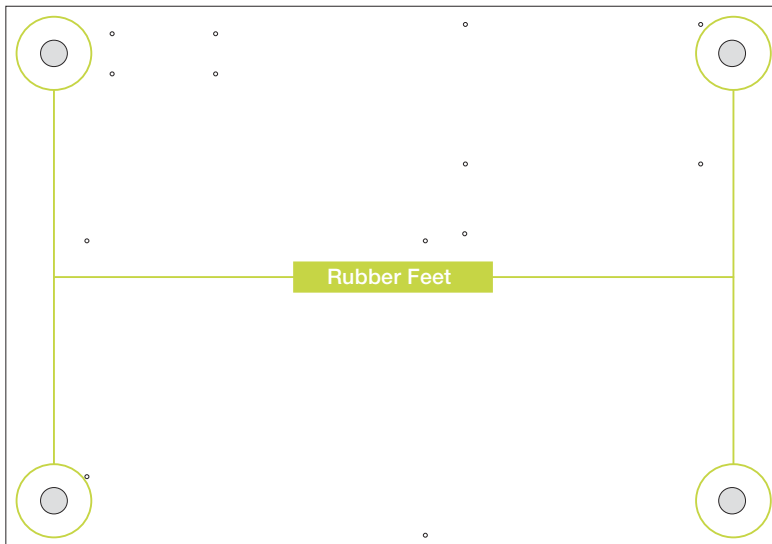
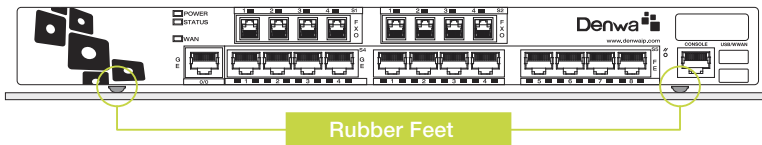

Be sure the central surface is cleaned and dried before pasting the rubber feet. If it is necessary, clean the surface with alcohol.

SERIAL NUMBER AND LICENSE

1. Serial Number: this number is on the chassis below the central.
2. License Number: you can find a copy of this number on page two of the installation guide.
3. The serial number on the chassis must be the same with the number that is on the installation guide.

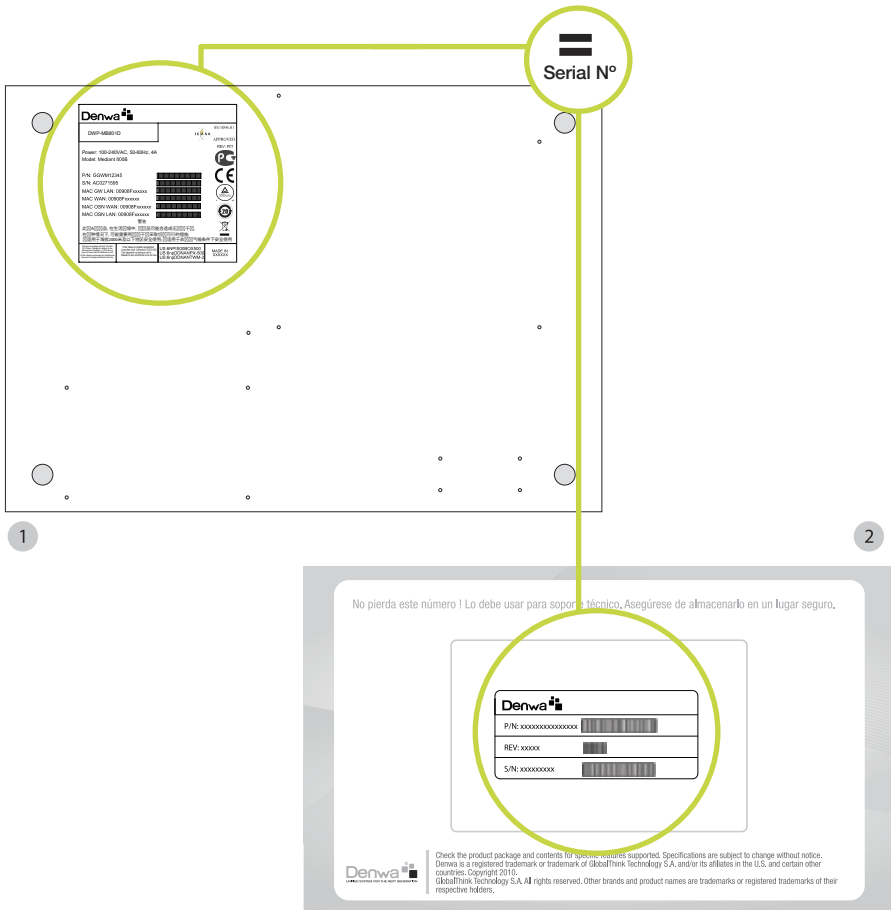

ACTIVATION

Connections

To carry out the activation process, you have to connect the equipment to the electrical supply (110-220V) by power cable included in the kit. Then, you have to connect a PC with DHCP to Denwa Premium switch, and a network cable that provides internet to WAN interface, as it is shown in the following picture:

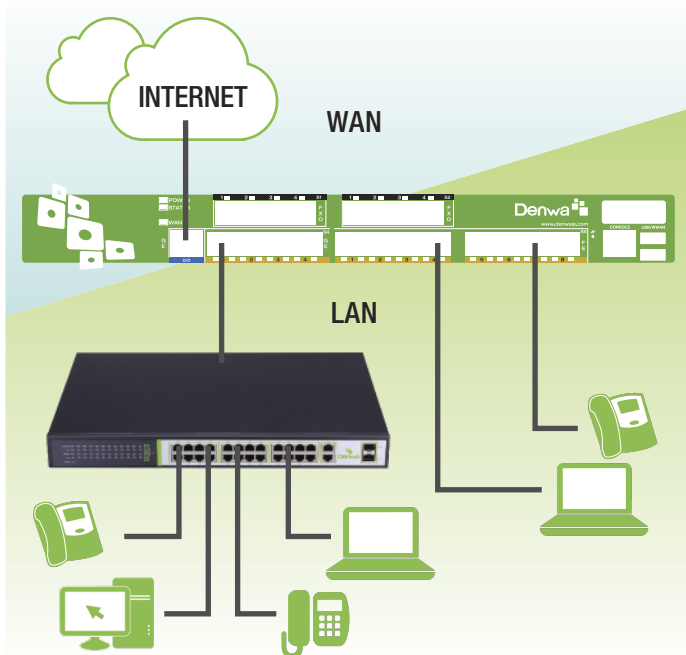

Procedure

Once you complete the connections, you have to enter URL <http://192.168.237.3/> on a web browser (Internet Explorer, Mozilla Firefox, Google Chrome, etc) and it will open the following Denwa UC central page.



The image shows the Denwa login interface. In the top left corner, there is a Denwa logo with the text 'UNIFIED COMMUNICATIONS' below it. The background is a green abstract design with flowing lines. On the right side, there is a login form. At the top of the form is a small cartoon character. Below it is a language selection dropdown menu labeled 'Idioma' with 'Español' selected. This is followed by two input fields for 'Usuario' and 'Contraseña'. Below these is a 'Perfil' dropdown menu with 'Usuario' selected. A link labeled '¿Olvidaste tu contraseña?' is positioned below the profile menu. At the bottom of the form is a dark 'Ingresar' button with a right-pointing arrow. The footer of the interface contains the text 'Powered by Denwa v.4.0.1 © Copyright 2009-2016 | www.denwaip.com'.

Denwa 
UNIFIED COMMUNICATIONS

Idioma
Español ▼

Usuario

Contraseña

Perfil
Usuario ▼

[¿Olvidaste tu contraseña?](#)

Ingresar 

Powered by Denwa v.4.0.1 © Copyright 2009-2016 | www.denwaip.com

You enter with the user/password: admin/admin. (It is advisable to change this password for security reasons).

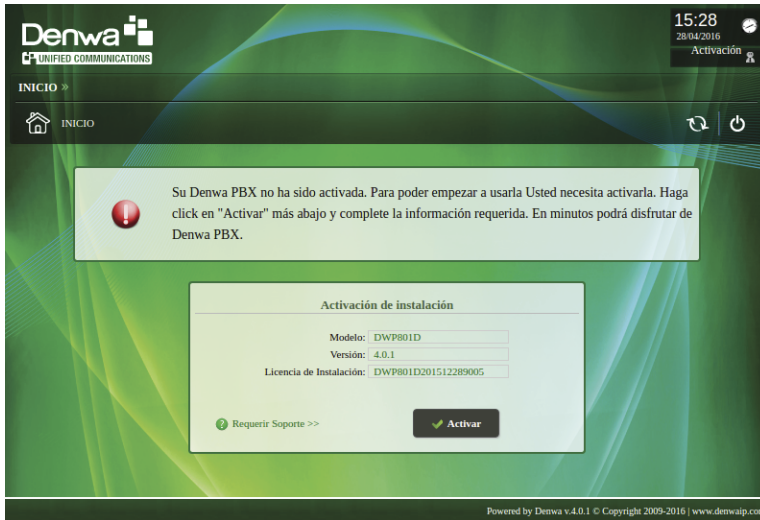

You have to click on **Activate**.

If the connections are not carried out as it should be, you could have some problems. You will see the following message, if you have not done the connections to the WAN port.

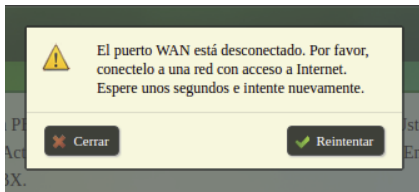

You connect the corresponding cable on the WAN port (see the front panel, each port is identified) and click on retry.

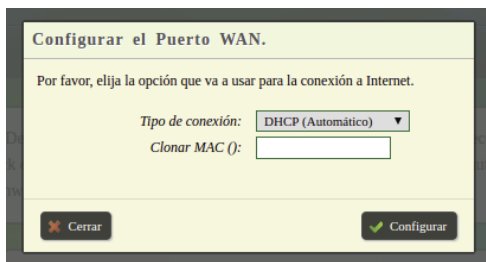

If the configuration of your WAN port is DHCP click Configure.
Otherwise select other types of connections from the dropdown menu.

- Configure WAN port with PPPoE
- Configure WAN port manually

Configurar el Puerto WAN.

Por favor, elija la opción que va a usar para la conexión a Internet.

Tipo de conexión:

Usuario:

Contraseña:

Clonar MAC ():

Configurar el Puerto WAN.

Por favor, elija la opción que va a usar para la conexión a Internet.

Tipo de conexión:

Dirección IP:

Máscara:

Puerta de enlace:

Clonar MAC ():

Modelo: DWB00113

 Configurando.

Once the IP of the WAN interface is established, you have to upload the information and click on **Activar**.

Activación de instalación.

Complete los siguientes datos. Los campos marcados con (*) son obligatorios.

Información de la Compañía

Compañía: *
País: -- Elija su país --*
Estado/Provincia:
Ciudad: *
Dirección:
Cod. Postal:
Teléfono: *

Contacto Comercial

Nombre: *
Email: *

Contacto Técnico

Nombre: *
Email: *

Número de Licencia

Licencia: *

✖ Cancelar

✔ Activar

The automatic activation process begins. Please do not disconnect any cable until the process is finished.

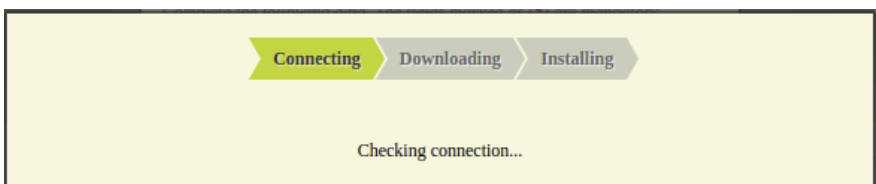

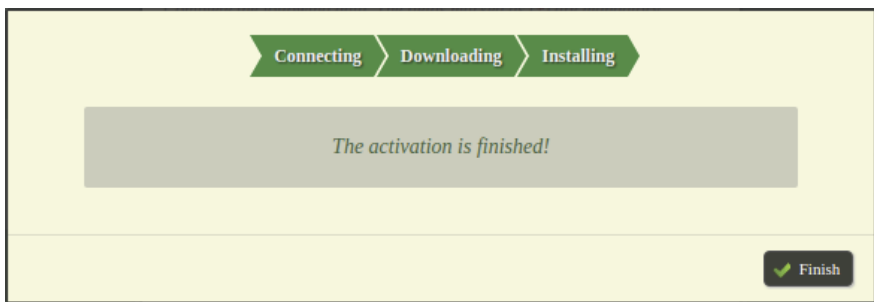
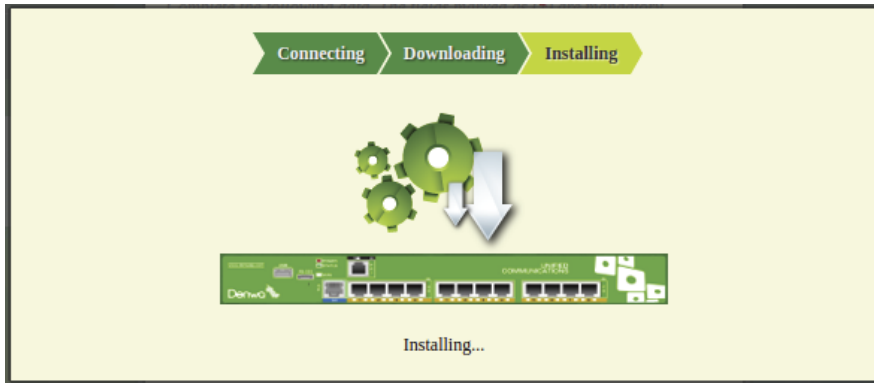
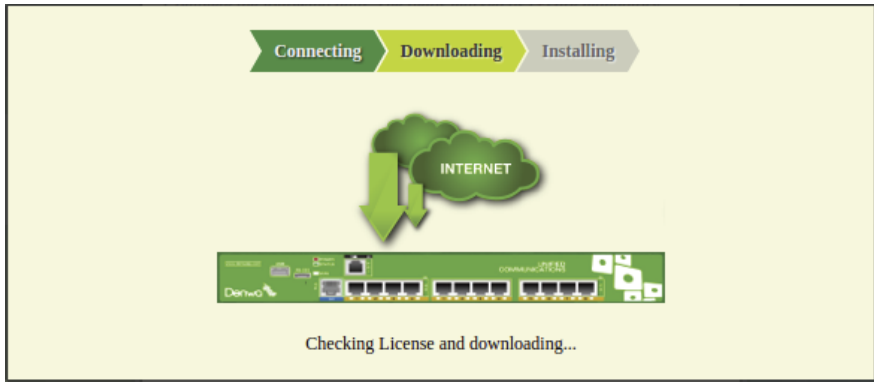

Finally, you have to click on **FINISH** and the equipment will be ready to use.



UNIFIED COMMUNICATIONS



Idioma
Español ▼

Usuario

Contraseña

Perfil
Usuario ▼

[¿Olvidaste tu contraseña?](#)

Ingresar 

Powered by Denwa v.4.0.1 © Copyright 2009-2016 | www.denwaip.com

GLOBAL WARRANTY

Limited equipment warranty

In case you want the refund by warranty, you have to include the product identification (including the model and serial number), box with the original product and a description about the failure that the product has.

It also has to be included a clear evidence about the purchasing date (bill) to show that the equipment is on warranty period.

Limited warranty: 1(one) year



**Denwa Technology Corp.
Florida, USA**

**sales@denwaip.com
www.denwaip.com**

Denwa products are available worldwide and supported by Denwa Regional

Offices throughout the world. For a complete list of local Denwa Sales and Technical Support contacts, visit our worldwide website at **www.denwaip.com**